

Shuttle[®] Go

Curtain motor



Forest Link RF
Protocol inside



Wi-Fi
connectivity

523600X000-EU

523600X000-UK

523600X000

USER MANUAL

TABLE OF CONTENTS

1. General	3
1.1 Specifications	3
2. Product overview	4
2.1 Contents	4
2.2 Main parts	4
2.3 Remote control button functions	5
2.4 P-button functionality	5
3. Safety	6
3.1 Intended use	6
3.2 Safety instructions	6
4. Installation	7
5. Use	7
5.1 Pairing to an EasyTouch® remote control	7
5.2 Pairing to an EasyTouch® wall switch	8
5.3 Adding an additional remote control via a paired remote control	8
5.4 Adjusting stack back	9
5.5 Reverse direction	9
5.6 Touch Control	10
5.7 Set favourite position	11
5.8 Recalibrate end positions	11
5.9 Adjusting motor speed	12
5.10 Unpairing a remote control	13
5.11 Cancelling the set limits	13
5.12 Adjust obstacle detection sensitivity	14
5.13 Change dry contact mode (RJ#12)	15
5.14 Factory reset	16
6. App connectivity	17
7. Troubleshooting	19
8. Maintenance	19
8.1 Lubrication	19
9. Conformity	20
10. Liability	20
11. Recycling	20
12. Declaration of conformity	21

INTRODUCTION

- 3** Thank you for purchasing the Forest Shuttle® Go curtain motor!
- 4** The Forest Shuttle® Go motor is a curtain motor for use with Forest track systems.

1. General

Read this manual and the safety instructions carefully before using this Forest Group product. Follow the instructions in this manual and keep it throughout the entire lifespan of the product. This manual describes the installation and operation of the Shuttle® Go curtain motor.

Any use beyond the application scope defined by Forest Group is not permitted. Ignoring the instructions in this manual voids any liability and warranty from Forest Group.

The Shuttle® Go curtain motor features:

- Bluetooth® and Wi-Fi connectivity
- Works with Forest Connect app
- Can be used with curved track
- Supports dry contact control
- Up to 35 kg (no curves) weight load
- Touch Control activated by pulling the curtains
- Integrated Emergency Control, in case of power failure, to ensure manual operation of the curtains
- Slow start and slow stop
- Full automatic setting of the limits
- Adjustable speed setting
- 5 Year warranty

EN

1.1 SPECIFICATIONS

Specifications	Value
Motor weight	1 kg
Motor dimension	50 × 71 × 290 mm
Cable length	4 m
Voltage	110 – 230 V AC
Power	24 W
Protection rating	IP20
Operating temperatures	-10°C – 50°C
Relative humidity	10 – 80%
RF Protocol	Forest Link Protocol
RJ12 port	Dry contact
RF range	30 m
Motor torque	1 Nm
Receiver	433MHz/ASK
	Bluetooth®
	Wi-Fi
Max. remote control connections	10
Speed	1: 12 cm/s
	2: 14 cm/s
	3: 16 cm/s
Max. continuous operation	360 s
Max. curtain weight	No curves: 35 kg
	One curve: 30 kg
	Two curves: 25 kg

2. Product overview

2.1 CONTENTS

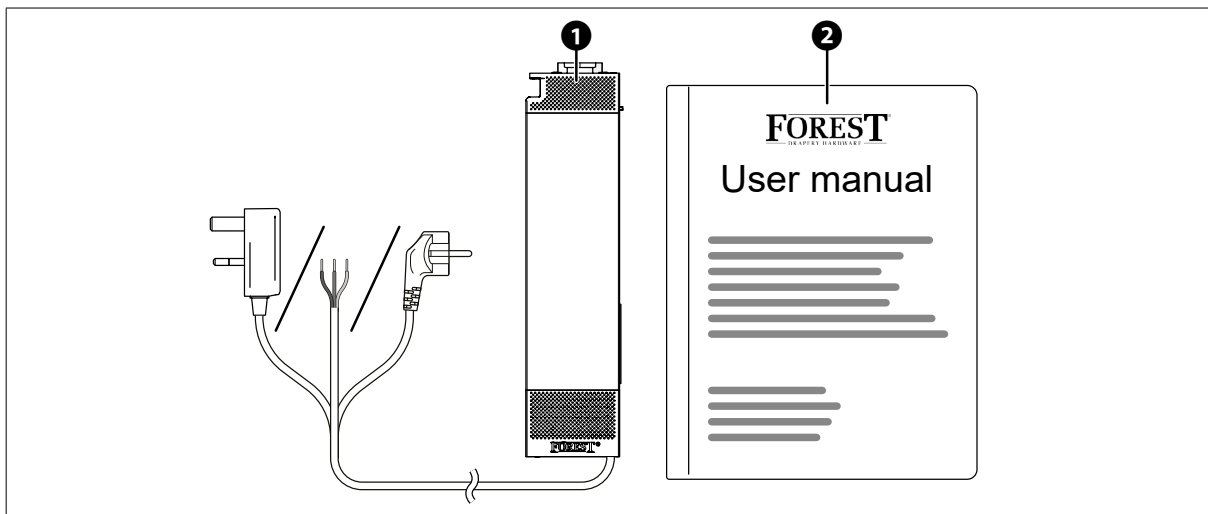

- 1 1× Shuttle® Go curtain motor
- 2 1× User manual



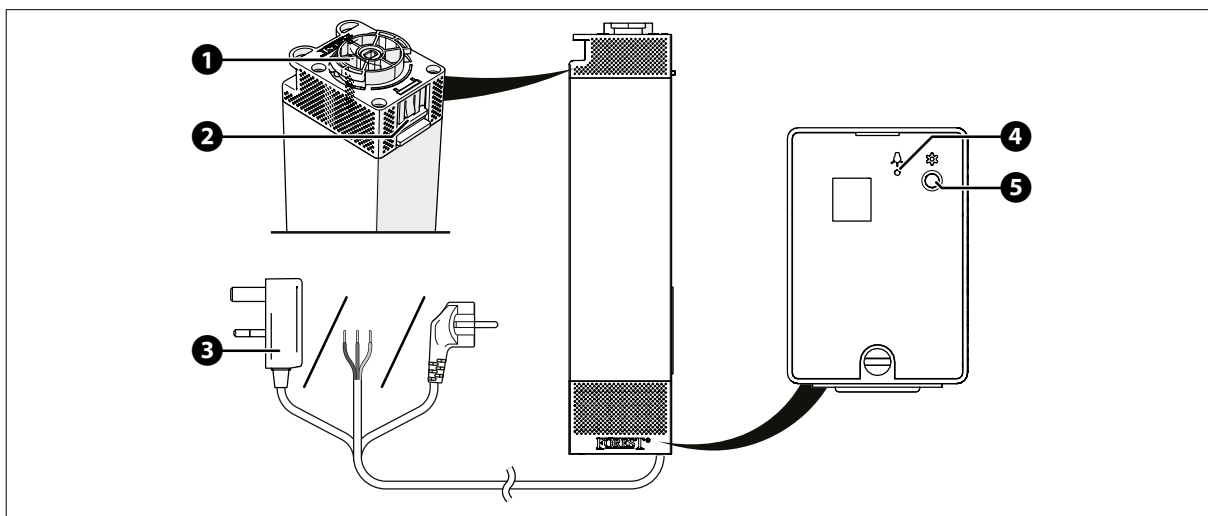



2.2 MAIN PARTS



- 1 Motor shaft
- 2 Locking clip
- 3 Power cable¹
- 4 LED indicator
- 5 P-button

¹Power cable is dependent on the location of purchase: 5236001000-EU is equipped with an EU power plug. 5236001000-UK is equipped with a UK power plug. 5236001000 is equipped without a plug (grounded power plug must be purchased and installed separately).

2.3 REMOTE CONTROL BUTTON FUNCTIONS

Button	Function	Button	Function
	Press the Open button to open the curtains.		Used in programming of the functions.
	Press the Close button to close the curtains.	 	Press to move to the next or previous channel ¹
	Press to stop the current operation/movement.		
	Press to access your favourite curtain position.		

¹These buttons are not present on the wireless wall switch.

2.4 P-BUTTON FUNCTIONALITY

Use the P-button to change settings in the configuration menu. Choose the setting you want to change and press the button that many times (corresponding with the setting). Confirm the desired setting by pressing the button for 3 seconds.

Function	Amount of P-button presses	LED indicator		Options	LED confirmation	Factory setting
Invert motor direction	1		Green	Clockwise	3 green flashes	Clockwise
				Anti-clockwise	5 green flashes	
Activate Wi-Fi pairing	2		White	Easy mode	Flashes blue	-
				Connection established	LED off	
RF 433 Mhz pairing	3		Orange	RF pairing mode	Flashes orange	-
				RF connection established	LED off	
Recalibrate	4		Blue	Reset	Flashes blue while calibrating	-
Dry contact method	5		Yellow	Pulse mode	3 yellow flashes	Pulse mode
				Continuous mode	5 yellow flashes	
Currently unused	6		Purple	-	-	-
Currently unused	7		Turquoise	-	-	-
Factory reset	8		Red	-	5 red flashes	-

3. Safety

3.1 INTENDED USE

- This product is intended as a curtain motor for Forest track systems.
- This product is intended for use with a Forest remote control with Forest Link protocol.
- This product is not intended for use by persons (including children) with reduced physical, sensory or mental capabilities, or lack of experience and knowledge, unless they have been given supervision or instruction concerning use of the product by a person responsible for their safety.
- This product is only intended for indoor use.

3.2 SAFETY INSTRUCTIONS

WARNING

- Always read and understand this manual and keep this document close to the product at all times. Go to www.forestgroup.com for the online version of the extended user manual.
- Children should be supervised to ensure that they do not play with the product.
- Never use the product with a damaged power cable. Always have the power cable replaced by a qualified electrician.

CAUTION

- Do not expose the product to high temperatures or place it in direct sunlight.
- This product is for indoor use only, do not use in outdoor or in humid environments, such as bathrooms or swimming pools.
- Never let children play with the packaging material. Always keep the packaging material out of reach of children.
- Do not carry the product by the power cable.
- Do not open the product, there are no serviceable parts inside.

NOTICE

- Never immerse the product in liquid.
- Do not drop the product, drill holes in it, or disassemble it, as this will void the warranty.
- Always wait for the motor to finish its operation before sending new instructions.
- Power to the motor should not be cut due to a building management system or a hotel room key card. This is considered misuse of the product, can lead to product damage, and will void the warranty.
- When used with wave pleat, the curtains must be manufactured so that the top heading does not rub against the track profile. This can increase friction and leads to excessive strain on the motor, resulting in product damage.
- Keep the power cable and product away from usual walkways.
- Always switch off the product and unplug the power cable from the power outlet before cleaning the product or performing maintenance on the product.
- Do not use aggressive chemicals, such as ammonia, acid, or acetone, when cleaning the product.
- Do not clean the inside of the product.

4. Installation

1. Install the **Forest track system** first.
2. Attach the **motor** to the track system and twist the motor anticlockwise.
3. Push the **locking clip** upwards to lock the motor to the track system.

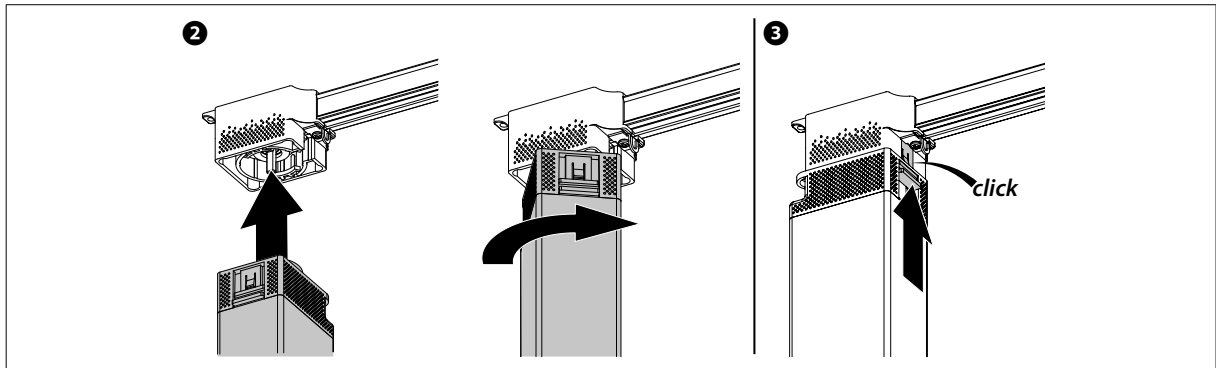

4. Attach your **curtains** to the **track**.
5. Manually slide the **curtains** to the open position.
6. Plug the motors **power cable** into a power outlet.
7. Grab the **curtains** and give them a short pull towards the closed position.

The curtains automatically go to the closed position and back to the open position.

The motors open and closed positions are now set.

5. Use

5.1 PAIRING TO AN EASYTOUCH® REMOTE CONTROL

1. Select the **desired channel**.
2. Press the **P button** on the Shuttle 3 times.

The LED indicator on the motor is orange.

3. Press and hold the **P button** a 4th time, for 3 seconds.

The LED indicator on the motor flashes orange.

4. Within 10 seconds, press the **Open button** on the remote to pair the Shuttle to the remote.

The curtain jogs once, indicating the remote is paired.

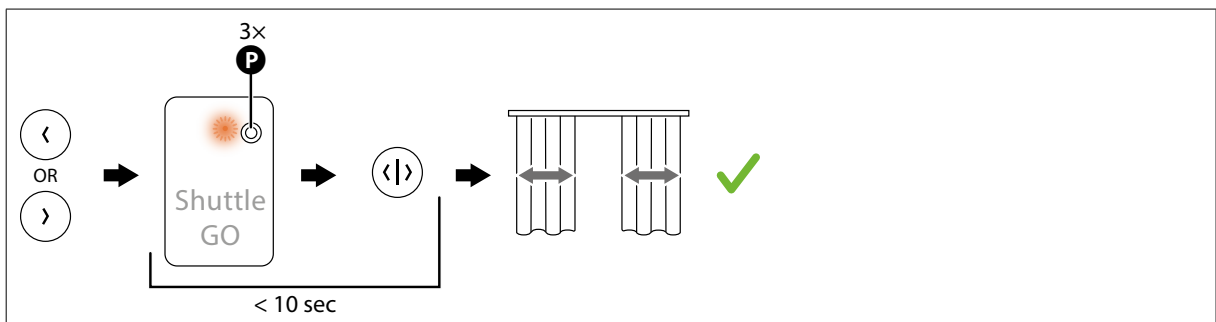

5.2 PAIRING TO AN EASYTOUCH® WALL SWITCH

1. Press the **P button** on the Shuttle 3 times.

The LED indicator on the motor is orange.

2. Press and hold the **P button** a 4th time, for 3 seconds.

The LED indicator on the motor flashes orange.

3. Within 10 seconds, press the **Open button** on the remote to pair the Shuttle to the remote.

The curtain jogs once, indicating the remote is paired.

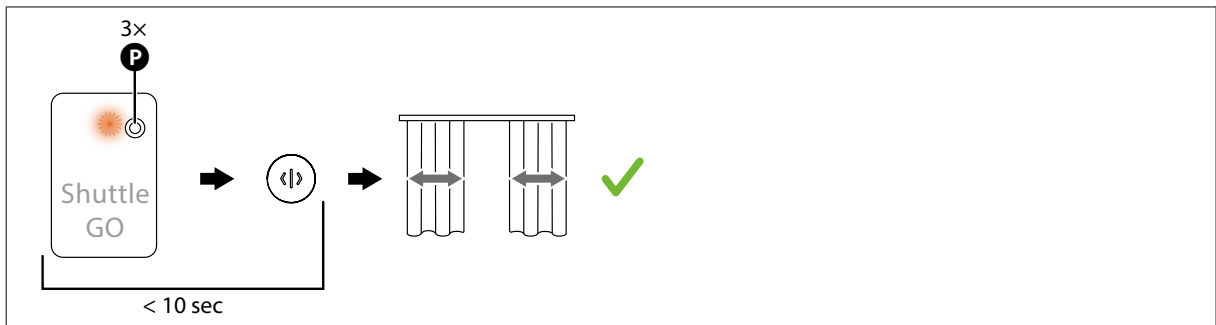

5.3 ADDING AN ADDITIONAL REMOTE CONTROL VIA A PAIRED REMOTE CONTROL

A second remote control (B) can be paired to the motor via an already paired remote control (A).

1. Press the **Programme button** on the paired remote control (A).

The curtains jog once.

2. Press the **Programme button** on the paired remote control (A) again.

The curtains jog once.

3. Press the **Stop button** on the additional remote control (B).

The curtains jog once.

The additional remote control (B) is now also paired to the motor.

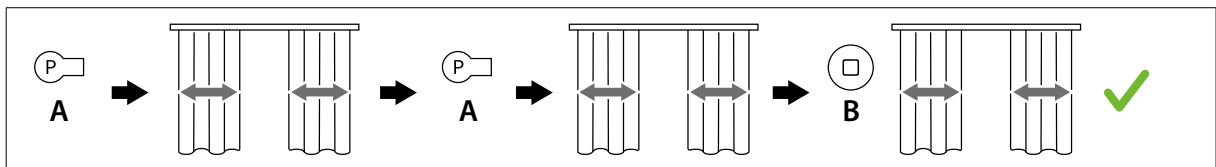

5.4 ADJUSTING STACK BACK

To set your desired curtain stack setting:

1. Use the **Open**, **Close**, and/or **Stop** buttons to move the curtains to the desired position.

Wait for the curtains to stop moving.

2. Press and hold the **Open** and **Favourites** buttons for 3 seconds.

The curtains jog twice.

The new curtain stack is now set.

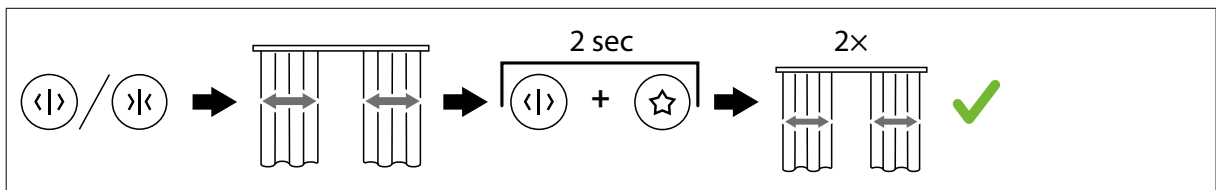

Repeat steps 1 – 2 to delete the stack back.

5.5 REVERSE DIRECTION

Make sure pressing the **Open button** opens the curtains and the **Close button** closes the curtains.

If the **Open button** closes the curtains, reverse the curtain directions below.

Option via motor:

1. Press the **P button** once.

The LED indicator on the motor is green.

2. Press and hold the **P button** for 3 seconds until the LED indicator flashes green.
3. Press the **Close button**.

The curtains jog once.

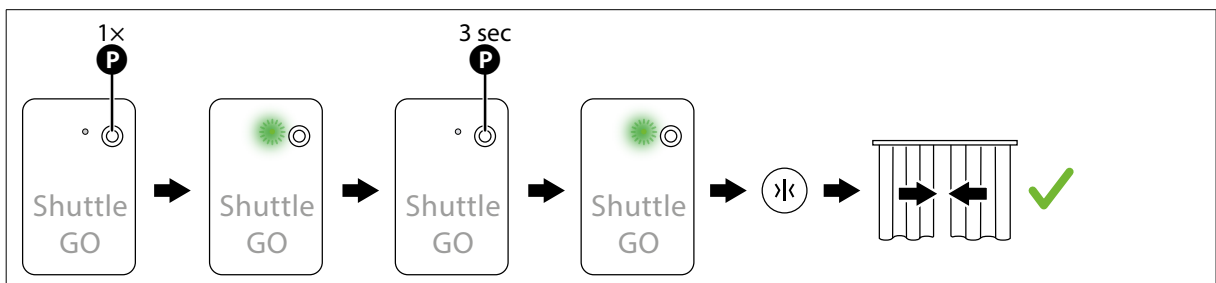

Option via remote:

1. Press the **Programme button** on the remote control.

The curtains jog once.

2. Press the **Open button**.

The curtains jog once.

3. Press the **Close button**.

The curtains jog once.

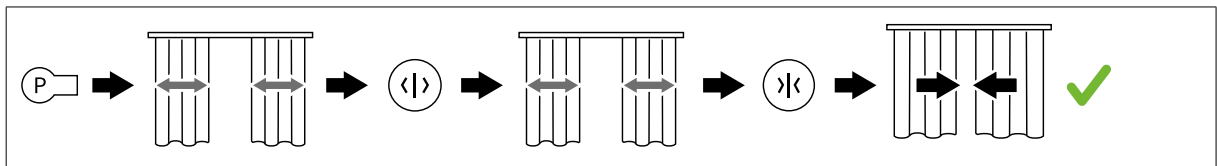

5.6 TOUCH CONTROL

Touch Control is switched on by default.

Touch Control allows you to open and close the curtains by manually giving the curtains a pull to the open or closed position.

To (de)activate touch Control:

1. Press the **Programme button** on the remote control.

The curtains jog once.

2. Press the **Stop button**.

The curtains jog once.

3. Press the **Stop button**.

The curtains jog once.

Touch Control is now (de)activated.

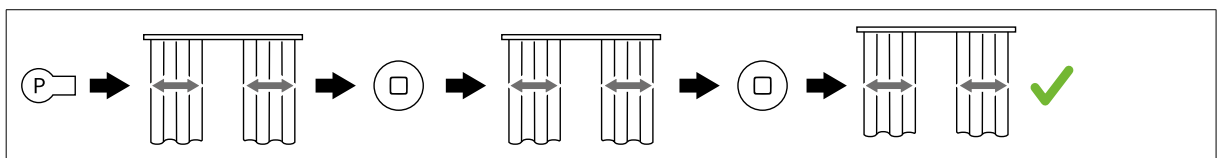

Repeat the steps above to (de)activate touch Control.

5.7 SET FAVOURITE POSITION

The favourite button allows you to set a custom curtain position for each motor. Pressing the button moves the curtain automatically to the specified position.

Favourites can only be setup if the end positions of the motors are configured.

1. Use the **Open**, **Close**, and/or **Stop** buttons to move the curtains to the desired favourite position.
2. Press the **Favourite** and **Stop** button for 2 seconds to setup the current position as the favourite.
3. Press the **Favourite** button from any position to move the curtains to the favourite position.

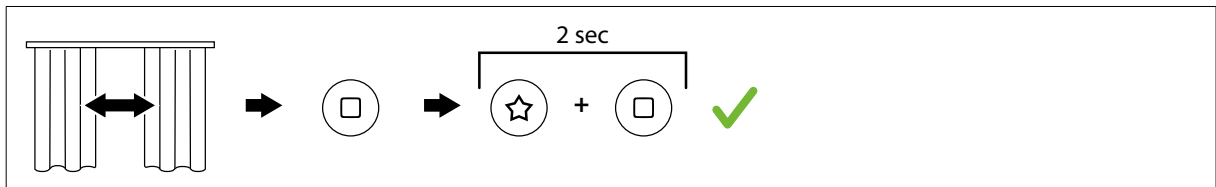

To remove the favourite position:

1. Press the **Favourite** button from any location to move the curtains to the favourite location.
2. Press and hold the **Favourite** and **Stop** button for 3 seconds.

The favourite position is now removed.

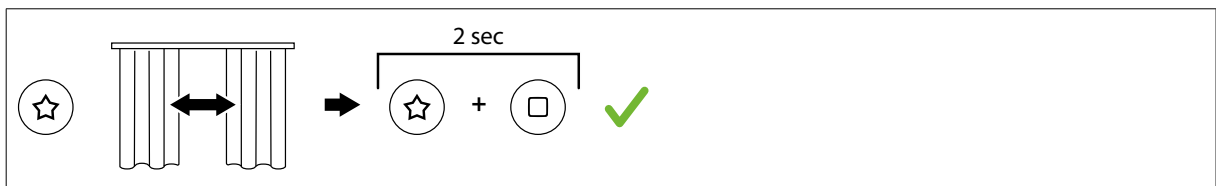

5.8 RECALIBRATE END POSITIONS

To recalibrate the end positions:

1. Press the **P** button on the motor 4 times.

The LED indicator on the motor flashes blue.

2. Press and hold the **P** button a 5th time, for 3 seconds.

The LED indicator flashes blue.

The curtains automatically go to the closed position and back to the open position.

NOTE: Do not force the motor to stop running during the automatic open close setting. The motor will stop automatically after the stroke is set if there is resistance on both sides.

The motors open and closed positions are now set.

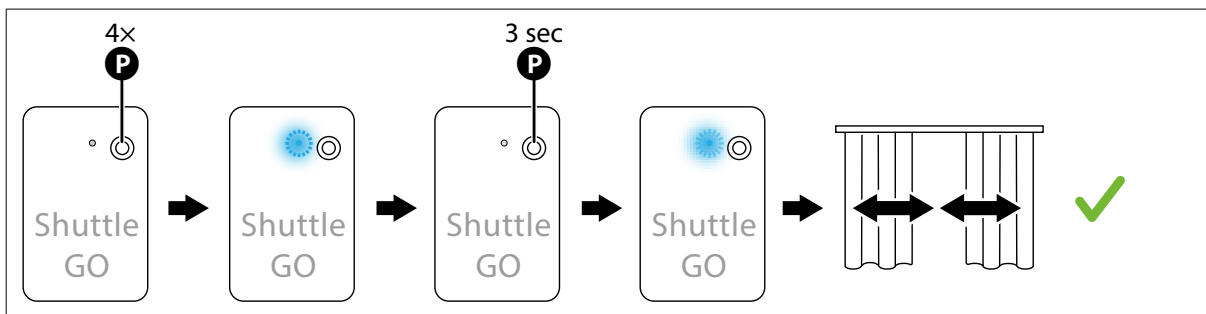

EN

5.9 ADJUSTING MOTOR SPEED

To adjust the motor speed:

1. Press the **Programme button** on the remote control.

The curtains jog once.

2. Press the **Stop button**.

The curtains jog once.

3. Adjust the motor speed:
 - a. Press the **Open button** to increase the setting.
 - b. Press the **Close button** to decrease the setting.

The curtains jog once.

The motor has three adjustments. If the motor does not respond after an adjustment, the motor is already at the highest/lowest setting.

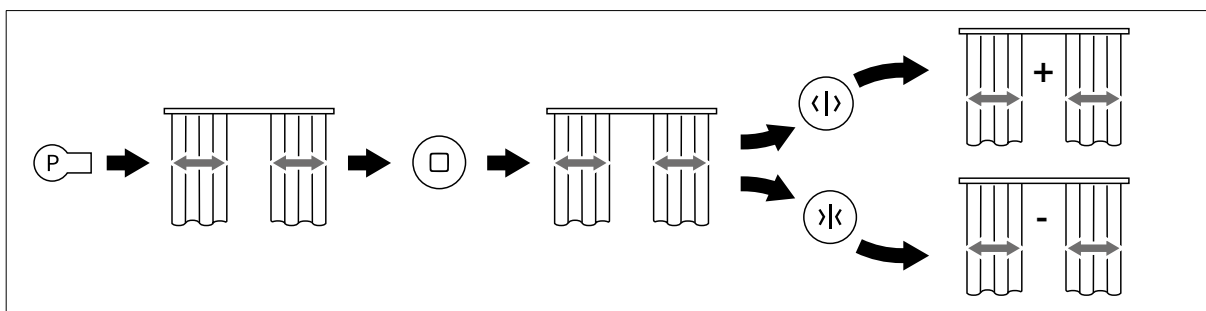

5.10 UNPAIRING A REMOTE CONTROL

To unpair a remote from the motor:

Unpairing a remote can not be done under group channel or 0 channel.

1. Press the **P button** on the motor 3 times.

The LED indicator on the motor flashes orange.

2. Press and hold the **P button** a 4th time, for 3 seconds.

The LED indicator flashes orange.

3. Press the **Close button** and wait 10 seconds

The curtains jog once.

The remote control is now unpaired.

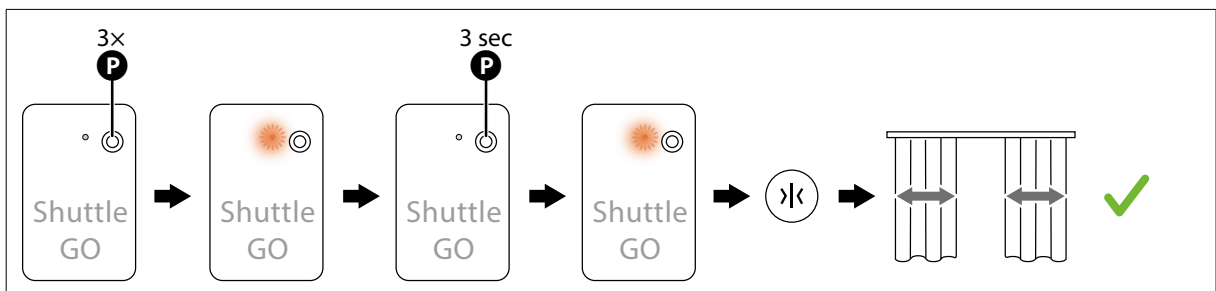

5.11 CANCELLING THE SET LIMITS

If the curtain tracks or the curtain fabric is changed, the open and close limits might need to be reset.

To cancel open and close limits:

1. Press the **Programme button** on the remote control.

The curtains jog once.

2. Press the **Stop button**.

The curtains jog once.

3. Press the **Programme button** on the remote control.

The curtains jog once.

The previously set limits are now cancelled.

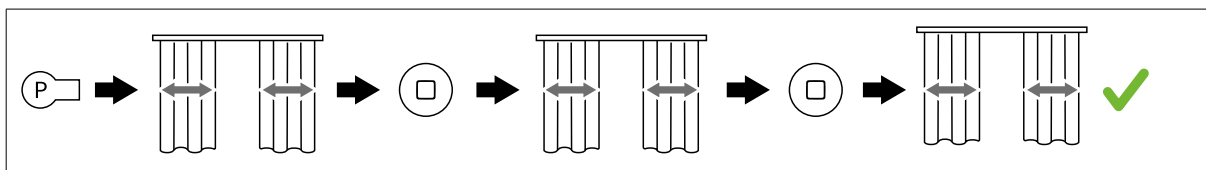

Follow steps 5 - 7 in 'installation' to set the new open and close limits.

5.12 ADJUST OBSTACLE DETECTION SENSITIVITY

EN

To set a higher or lower obstacle detections sensitivity:

1. Press the **Programme button** on the remote control.

The curtains jog once.

2. Adjust the obstacle detection sensitivity:
 - a. Press the **Open button** to increase the setting.
 - b. Press the **Close button** to decrease the setting.

The curtains jog once.

3. Press the **Open** or **Close button** that you pressed in step 2 again.

The curtains jog once.

The motor has three adjustments. If the motor does not respond after an adjustment, the motor is already at the highest/lowest setting.

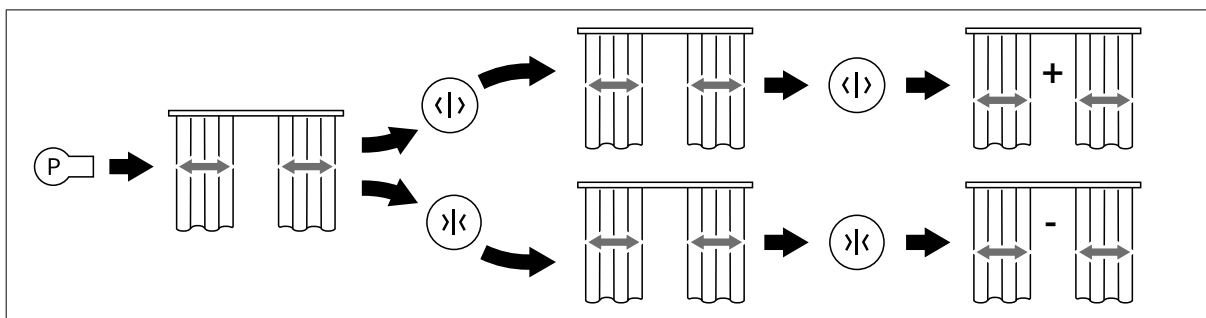

5.13 CHANGE DRY CONTACT MODE (RJ#12)

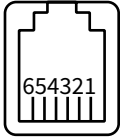
RJ#12		
1 (white)	Open	
3 (red)	COM	
5 (yellow)	Close	

Pulse mode

In pulse mode (default setting) a short contact opens or closes the curtains all the way.

Open	Close the open key (open+com)
Close	Close the close key (close+com)
Stop	Close the open key or close key
Switching characteristics	Double-key, boundable, with 3 wirings (open/close/com)

Continuous mode

In continuous mode the curtains move as long as the contact is made (mostly used for Home Automation Systems).

Open	Close the open key (open).
Close	Close the close key (close).
Stop	Release the open key and close key.
Switching characteristics	Double-key, not reboundable, with 3 wirings (open/close/com).

Switching dry contact modes

To switch from pulse to continuous or vice versa:

1. Press the **P button** 5 times.

The LED indicator on the motor is yellow.

2. Press and hold the **P button** a 6th time, for 3 seconds.

The curtains jog twice.

The LED indicator flashes 3 times to indicate the motor is in **pulse mode**.

The LED indicator flashes 5 times to indicate the motor is in **continuous mode**.

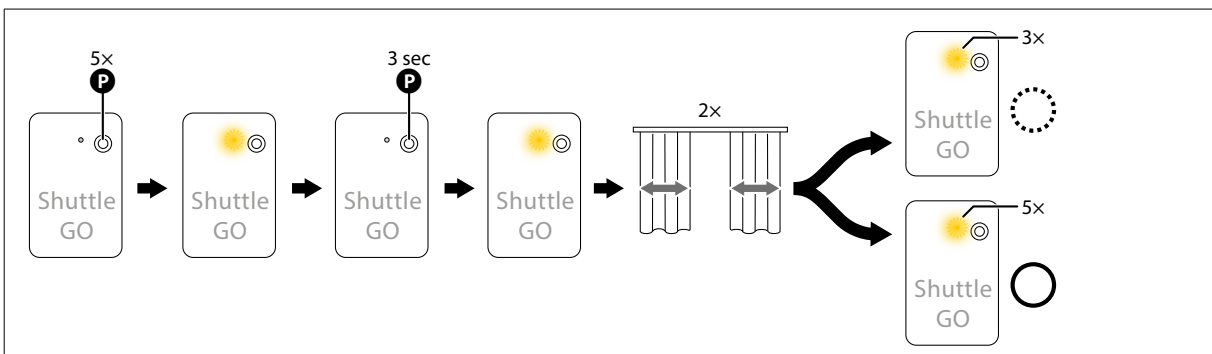

5.14 FACTORY RESET

To reset the motor to the factory settings:

1. Press the **P button** 8 times.

The LED indicator on the motor is red.

2. Press and hold the **P button** a 9th time, for 3 seconds.

The LED indicator flashes red.

The product is now reset to the factory settings.

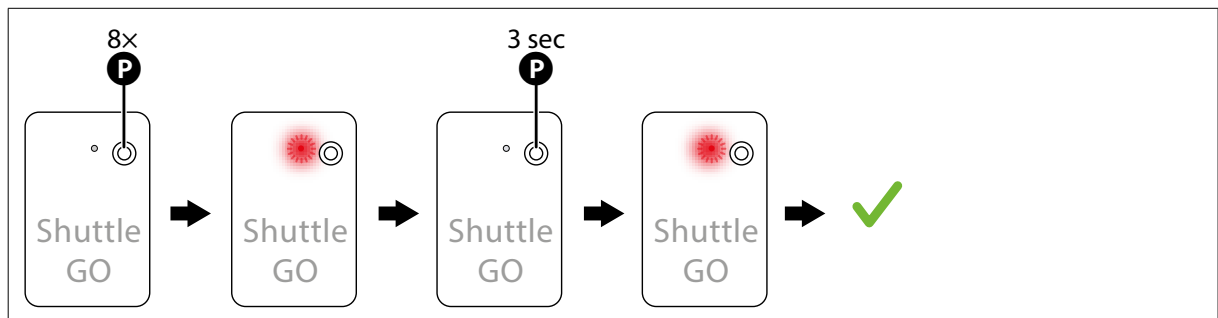

EN

6. App connectivity

Make sure you are connected to a **2.4 GHz Wi-Fi network**.

To connect the motor to the Forest Connect App:

Wi-Fi pairing mode:

1. Download the **Forest Connect App**.

Scan the QR code to download the Forest Connect App.



EN

2. Follow the steps in the app to **register** for the app.
3. Activate **pairing mode** on the motor:
 - A. Wi-Fi pairing mode via motor:
 - a. Press the **P button** 2 times.

The LED indicator on the motor is white.

- b. Press and hold the **P button** a 3rd time, for 3 seconds.

The LED indicator flashes blue.

The motor is now in Wi-Fi pairing mode.

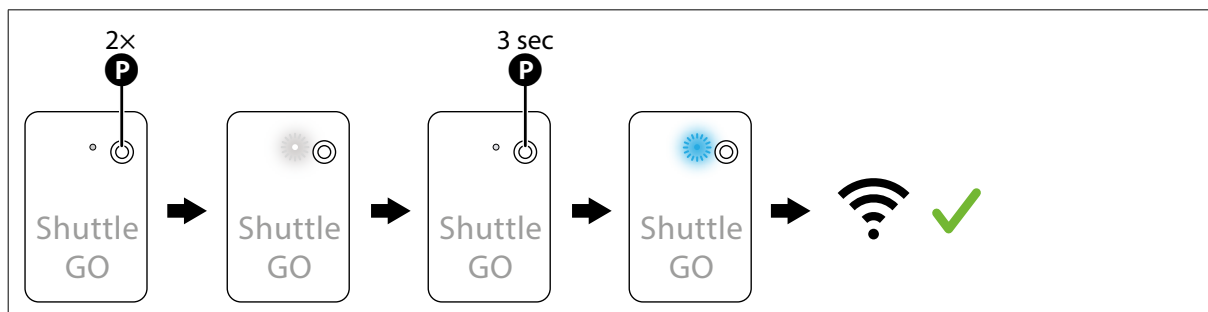

- B. Wi-Fi pairing mode via remote:
 - a. Press the **Programme button** on the remote control.

The curtains jog once.

- b. Press the **Close button**.

The curtains jog once.

- c. Press the **Open button**.

The curtains jog once.

The LED indicator flashes blue.

The motor is now in Wi-Fi pairing mode.

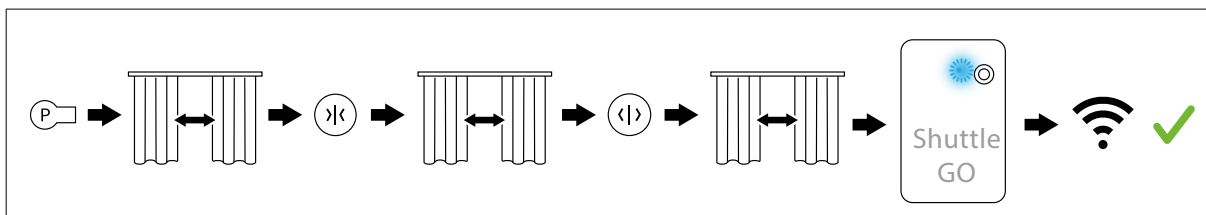

4. Make sure **Bluetooth®** and **Wi-Fi (2.4 GHz only)** are enabled on your mobile device.
5. Tap the **+** icon.
6. Tap **Add device**.

EN

The device scans for the motor.

7. Tap **motor** when it appeared on your device.
8. Follow the instructions in the app to pair motor to the app.

Manual pairing mode

AP Mode is used to manually connect the device to your Wi-Fi network through a temporary access point created by the motor itself. Use this method when Bluetooth® does not work or when you want full control over the setup process.

Make sure you are connected to a **2.4 GHz Wi-Fi network**.

1. Tap the **+** icon.
2. Select the **Forest icon**, under **Add Manually**.
3. In the right **upper corner** change the Bluetooth mode to **AP Mode**.
4. Follow the instructions in the app to pair motor to the app.

7. Troubleshooting

Problem	Possible cause	Possible solution
The motor runs, but the curtains do not move.	The curtain tracks are not installed correctly.	Check the curtain track and adjust if needed.
The remote control does not work.	The remote battery is empty.	Replace the battery.
The motor does not respond, but the LED indicator on the remote flashes.	The motor and remote are not paired.	Pair the remote to the motor.
The curtain gap is still too big in the closed position.	New parts have influenced the open and close limits.	Delete the current open and close limits and set new limits.
Manually pulling the curtains open/closed (Touch Control) does not work.	Touch Control is not activated.	Switch Touch Control on.

8. Maintenance

Maintenance is critical to ensure proper functioning of the motor and tracks:

- Inspect the motor and tracks for proper functioning at least once **every 3 months**. Fully close and open the curtains to inspect for proper functioning.

8.1 LUBRICATION

Lubricate the Forest tracks **annually** with Forest **dry** Lubricant Spray.

1. Spray the lubricant on the inside of the track profile.
2. Wait for the lubricant to settle.
3. Fully close and open the curtains.

- i** If Forest Lubricant is not available, you may use WD-40 Specialist® Dry Lube. Important: only use the Dry Lube variant with UPC code 0 79567 30005 2 (<https://www.wd40.com/products/dry-lube/>). Do not use a different type of lubricant like regular WD-40 or grease, as these react with the factory applied lubricant.

9. Conformity



Forest Group (Netherlands) B.V. hereby declares that the product complies with the requirements of Directive 2014/53/EU.

10. Liability

Forest Group does not assume liability for resulting damages to persons, animals and/or property, defects, labour on location, service calls, reinstallation or expenses involved shipping, packing or returning goods, if the product has been modified in any way or damaged by improper use or failure to observe these operating instructions. In such situation, the right to any form of warranty, service and reimbursement of expenses shall cease.

EN

11. Recycling



Do not dispose of the product with household waste. Ensure that you return it to a collection point or depot for recycling purposes.

12. Declaration of conformity



EU Declaration of Conformity

Hereby we, the undersigned:

Manufacturer: Forest Group Nederland B.V.
Address; city, Country: Teugseweg 42, 7418 AM Deventer, The Netherlands
Telephone number: +31 0570 622850

Declare that this DoC is issued under our sole responsibility and that this product:

Product description: Curtain Motor
Type designation(s): Shuttle Go
Model number: 523600x000 (x is colour variant)
Trademark: Forest

Object of the declaration:



Is in conformity with the relevant Union harmonization legislation:

<input checked="" type="checkbox"/>	Radio Equipment Directive – 2014/53/EU		
<input checked="" type="checkbox"/>	Article 3.1(a)	<input checked="" type="checkbox"/>	Article 3.2
	EN 60335-1:2012 + A11:2014 + A13:2017 + A1:2019 + A14:2019 + A2:2019 + A15:2021 + A16:2023 EN IEC 60335-2-97:2003 + A11:2023 + A1:2023 EN IEC 62311 : 2020		EN 300 220-1 V3.1.1 (2017-02) EN 300 220-2 V3.1.1 (2017-02) EN 300 328 V2.2.2. (2019-07)
<input checked="" type="checkbox"/>	Article 3.1(b)		
	EN 301 489-1 V2.2.3 (2019-11) EN 301 489-3 V2.3.2 (2023-01) EN 301 489-17 V3.3.1 (2024-09) EN IEC 55014-1:2021 & EN IEC 55014-1:2021 EN IEC 61000-3-2:2019 + A1:2021 EN 61000-3-3:2013+A1:2019+A2:2021		
<input checked="" type="checkbox"/>	RoHS directive – 2011/65/EU + amendment (EU) 2015/863		

Signed for and on behalf of:

Place: Deventer Name: A.G. ten Have

Date: 28-07-2025 Function: Head R&D

Signature:

EN

FOREST WORLDWIDE

FOREST GROUP (NEDERLAND) B.V.

Deventer, The Netherlands
www.forestgroup.com

FOREST DRAPERY HARDWARE UK LIMITED

Rochdale, United Kingdom
www.forestgroup.co.uk

FOREST GROUP POLSKA SP. Z O.O.

Warszawa, Poland
www.forestpolska.com

FOREST GROUP BULGARIA EOOD

Sofia City, Bulgaria
www.forestgroup.bg

FOREST DRAPERY HARDWARE USA

Cartersville, United States
www.forestdh.com

FOREST GROUP MIDDLE-EAST

Dubai, United Arab Emirates
www.forestgroupme.com

FOREST GROUP CHINA LTD

Shanghai, China
www.forestgroupchina.com

EN